



INSTRUCTION BULLETIN

No. 9015108
Machine: M17
Published: 04-2021
Rev. 01

NOTE: DO NOT DISCARD the Parts List from the Instruction Bulletin. Place the Parts List in the appropriate place in the machine manual for future reference. Retaining the Parts List will make it easier to reorder individual parts and will save the cost of ordering an entire kit.

NOTE: Numbers in parenthesis () are reference numbers for parts listed in Bill of Materials.

Installation instructions for **kit number 9015045**

SYNOPSIS:

This kit contains the parts needed to replace the drive wheel assembly on M17 sweeper- scrubbers. Please follow step-by-step instructions.

SPECIAL TOOLS / CONSIDERATIONS: NONE

(Estimated time to complete: 2 hours)

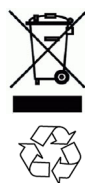

PROTECT THE ENVIRONMENT

Please dispose of packaging materials, used machine components such as batteries and fluids in an environmentally safe way according to local waste disposal regulations.

Always remember to recycle.

PREPARATION:

1. Empty the recovery tank and the solution tank before jacking up the machine.
2. Park the machine on a clean level surface, turn off the machine, set the parking brake, and remove the key.

FOR SAFETY: Before leaving or servicing machine, stop on level surface, turn off machine, and remove key.

3. Disconnect the battery cable from the machine.



WARNING: Always disconnect battery cables from machine before working on electrical components.

4. Chock both rear wheels.

5. Jack up the front end of the machine high enough to access the drive wheel assembly/ remove the drive wheel assembly from under the machine. Place jack stands under the machine frame and lower the machine onto the jack stands. Refer to *MACHINE JACKING* in the *MAINTENANCE* section of the operator manual for safety information and instructions for jacking up the machine.

FOR SAFETY: When servicing machine, block machine tires before jacking machine up. Use a hoist or jack that will support the weight of the machine. Jack machine up at designated locations only. Support machine with jack stands.

INSTALLATION:

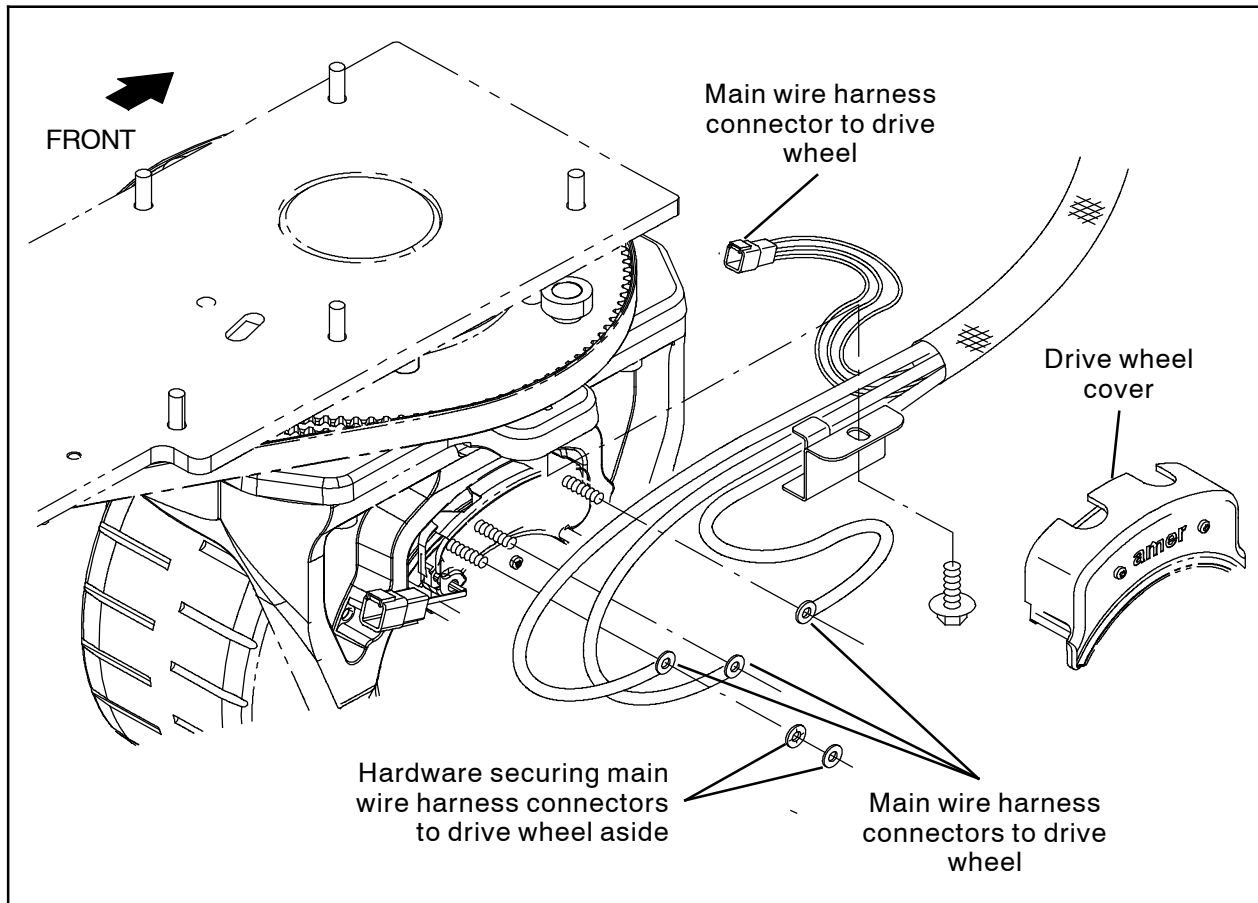

FIG. 1

1. Remove the cover from the drive wheel. Discard the cover and mounting hardware. (Fig. 1)
2. Disconnect all main harness connectors from the drive wheel. Note locations of nuts and washers securing the main wire harness connectors to the drive wheel. Nuts and washers must be arranged the same when connecting the main wire harness to the new drive wheel (1). (Fig. 1)
3. Loosen the four M12 socket screws securing the drive wheel to the output housing. Do not remove the four socket screws. (Fig. 2)
4. Jack the machine up off the jack stands, remove the jack stands from under the machine, and lower the machine to the floor.
5. Raise the jack until it is touching the frame, but not enough to raise the machine from the floor.
6. Remove the four previously loosened M12 socket screws. Set the M12 socket screws and flat washers aside. (Fig. 2)
7. Jack the machine back up off the floor, position the jack stands under the machine and lower the machine onto the jack stands.

NOTE: Use caution when removing the drive wheel as the brake is not engaged during the removal process. Carefully lower the drive wheel onto the ground.

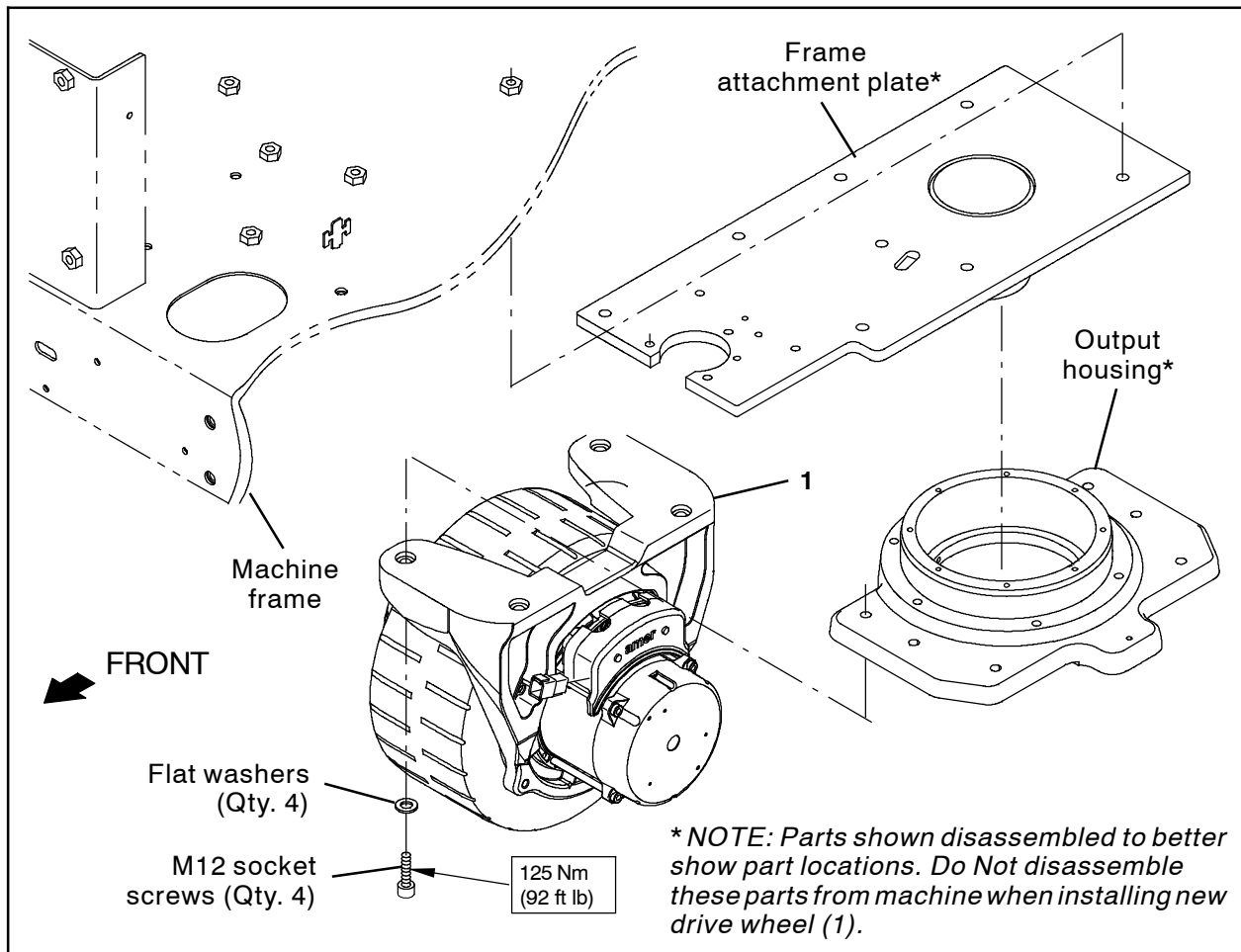

FIG. 2

8. Carefully remove the front drive wheel from under the machine. Discard the drive wheel. (Fig. 2)
9. Remove the cover from the new drive wheel (1). Set the cover and mounting hardware aside. (Fig. 1)
10. Remove hardware necessary to connect main wire harness connectors to the drive wheel (1). (Fig. 1)
11. Place the new drive wheel (1) onto the jack, position the jack underneath the machine, and raise the drive wheel up to the output housing. (Fig. 2)
12. Use the four M12 socket screws to safely secure the drive wheel (1) to the output housing. (Fig. 2)
13. Remove the jack from under the machine.

14. Position the drive wheel completely against the steering stop. (Fig. 3)



FIG. 3

15. Tighten the four M12 socket screws to Torque the M12 socket screws to 125 Nm (92 ft. lbs). (Fig. 2)

16. Connect all main wire harness connectors to the drive wheel (1). Position/route cables exactly as shown so drive wheel cover can be installed in the following step. (Fig. 4/Fig. 1)

Arrange the hardware securing the main wire harness to the drive wheel exactly the same as it was when removed from the old drive wheel. Discard unneeded hardware. (Fig. 4/Fig. 1)

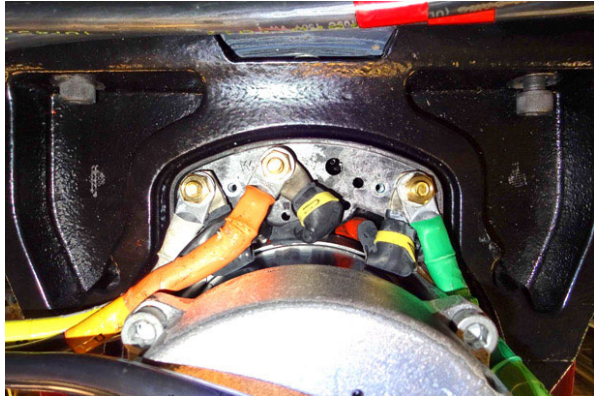

FIG. 4

17. Install the drive wheel cover onto the drive wheel (1). (Fig. 5/Fig. 1)

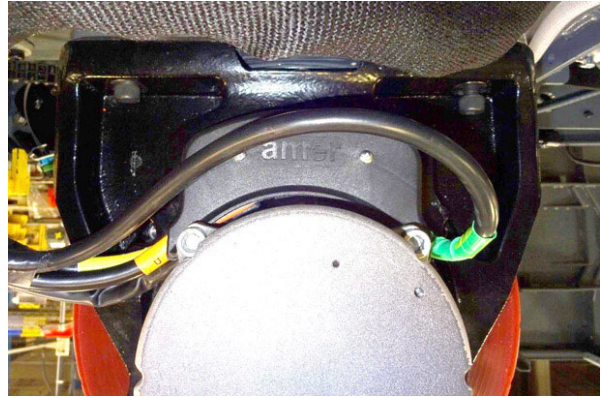

FIG. 5

18. Slightly raise machine from jack stands, remove the jack stands from under the machine, and lower the machine to the floor.
19. Reconnect battery cable to the machine.
20. Start and test machine to ensure the newly installed drive wheel (1) functions correctly. Operate the machine in both forward and reverse.

Bill Of Materials For Motor Rplmt Kit, Drive [M17] - 9015045

Ref.	Tennant Part No.	Description	Qty.
1	9013131	VR, Motor, Drive [Amer Replmt]	1

TENNANT COMPANY
 P. O. Box 1452
 Minneapolis, MN 55440-1452